

Erich-Weinert Straße 20, 10439, Berlin

The keys work the front door and obviously the apartment door. The rest of the interior doors are unlocked that lead you to the apartment door on the ground floor.

As you can see, once you're through the main entrance, go down the hall to the door at the end which opens to the courtyard. Bear left of the recycling area to the two doors. The door you want is on the left. The door to the 'Berber' Studio is at the end, on the right of the post boxes at the very bottom of the stairs.

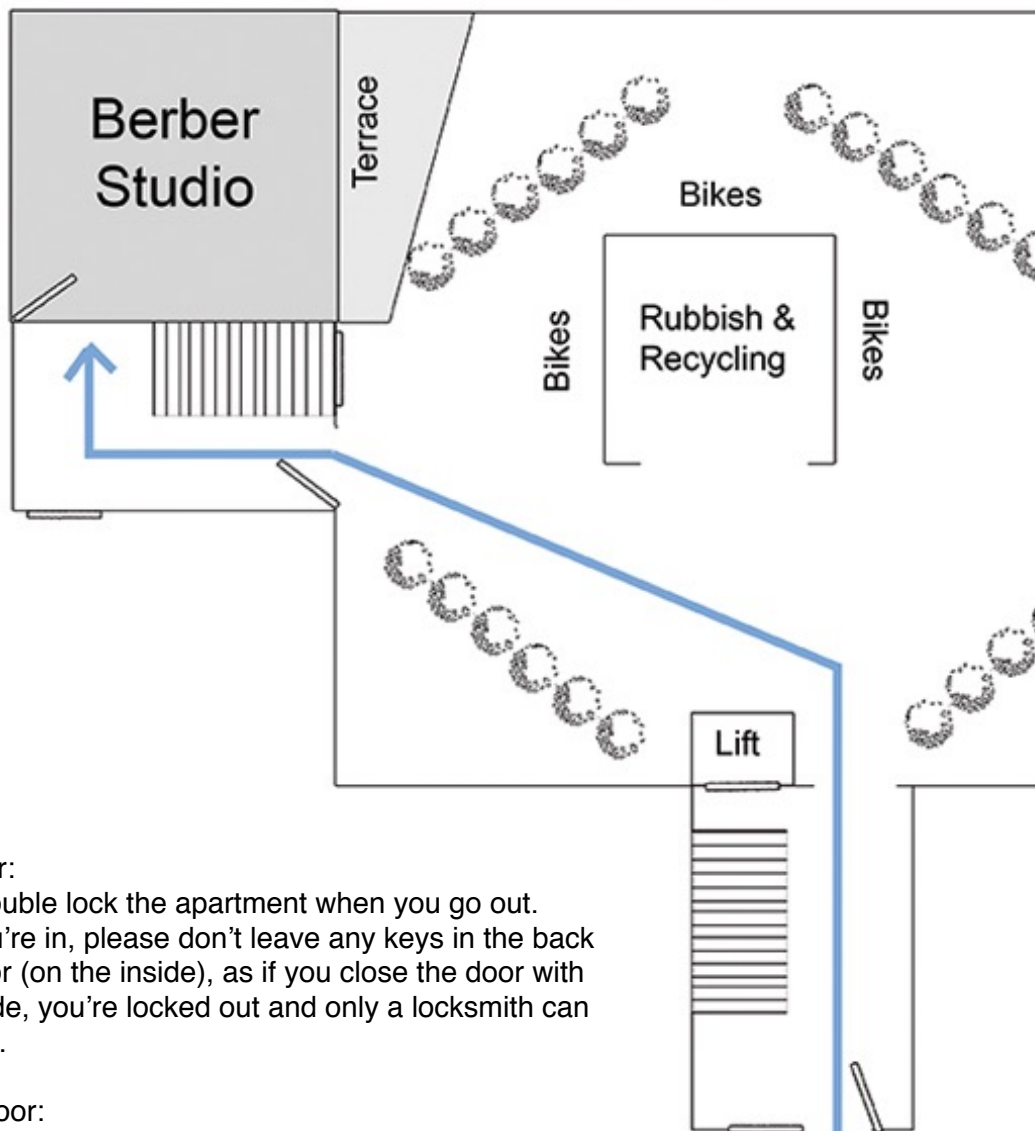

Front door:
Please double lock the apartment when you go out.
When you're in, please don't leave any keys in the back of the door (on the inside), as if you close the door with you outside, you're locked out and only a locksmith can get you in.

Terrace door:
To lock the terrace door, please make sure that the handle is at '6 O'clock' (handle pointing downwards).

Any problems, please call Phil: +49 176 4352 6571 or Rick: +49 176 4352 6637